

Introduction

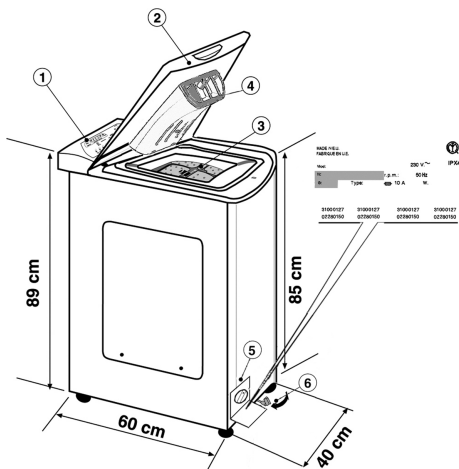

Read this manual carefully as it offers practical advice to help you get the most from your washing machine.

This «**Instruction and Installation Manual**» contains everything you need to know about the **everyday running** of your machine.

Please refer to this manual for **installation** and **maintenance** instructions. The manual also contains information about possible **working problems**, advice about **sorting clothes** for washing, an explanation of label symbols and hints about how to remove **stubborn stains**.

- 1.- CONTROL PANEL 2.- LID 3.- DRUM
4.- DETERGENT DISPENSER 5.- PLINHTT PANEL
6.- FILTER

Table of contents

| | page |
|--|------|
| Safety measures | 3 |
| Setting up - Installation | 5 |
| Guarantee | 6 |
| Preparing the wash. Opening/ closing the drum | 7 |
| Detergent load | 8 |
| Electronically-controlled variable load- Fuzzy Logic | 8 |
| Specific programmes | 9 |
| General recommendations | 10 |
| Troubleshooting | 12 |
| Washing hints | 13 |

Safety measures

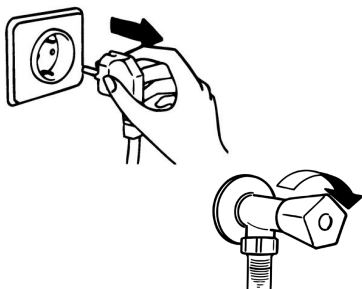

CE This appliance meets the European Directives 2004/108/EC, 2006/95/EC which have been substituted respectively by 89/336/EEC, 73/23/EEC and subsequent modifications thereof.

This appliance is not intended for use by persons (including children) with reduced physical, sensory or mental capabilities, or lack of experience and knowledge, unless they have been given supervision or instruction concerning use of the appliance by a person responsible for their safety. Children should be supervised to ensure that they do not play with the appliance.

ATTENTION: FOR ALL CLEANING AND MAINTENANCE WORK

- Remove the plug.
- Turn off the water inlet tap after each wash.

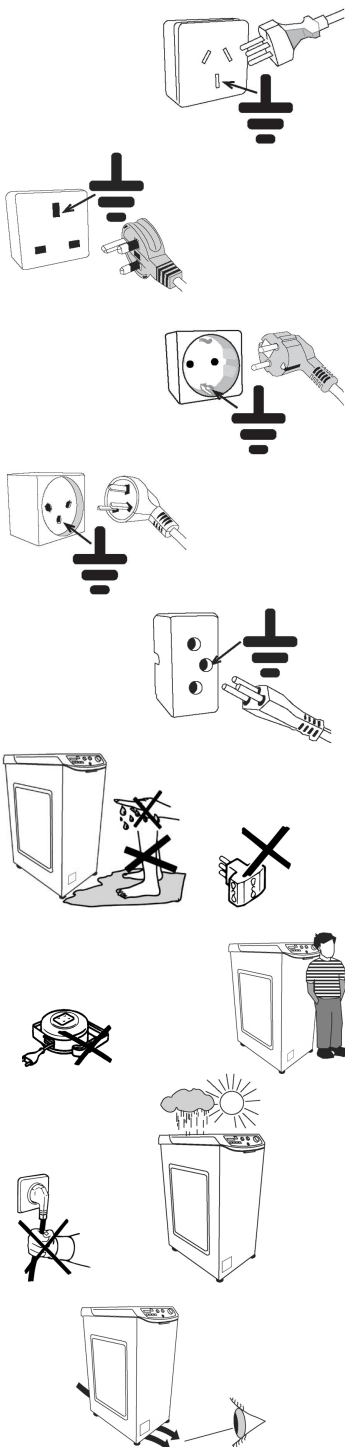

- The manufacturer fits all the machines with an earth connection.

Ensure that the electrical installation has an earth connection and that it is connected; if not, call a qualified Service Center.

The earth connection is essential for user safety as it eliminates the risk of electrical discharge.

- Power sockets should be in easily accessible places so that the washing machine can be unplugged in case of any problems.

- If the electric cable is damaged replace with an original set (cable and plug) supplied by the manufacturer or official after-sales service.

note:

In the event that it is necessary to replace the power cable, make sure that you comply with the following colour-code chart during the wiring:

| | |
|--------------|---------|
| blue | neutral |
| brown | phase |
| Yellow-green | earth |

The manufacturer accepts no responsibility for any damage to people or things resulting from the failure to comply with the appliance's installation and safety regulations.

- Do not touch the appliance with wet hands or feet.
- Do not use the appliance when bare-footed.
- Use extension cords only with extreme care.
- Do not use adapters or multiple plugs.
- Do not allow the appliance to be used by children or the infirm without due supervision.
- Do not pull on the power cord or the appliance itself to remove the plug from the socket.
- Do not leave the appliance outdoors or exposed to the atmospheric elements (rain, sun, etc.).
- Do not cover the appliance with cloth or plastic while it is working.
- Do not install the appliance in damp places or anywhere where it could be sprayed by the shower.
- Do not install the appliance on a surface which obstructs the space between the floor and the base of the machine.
- Keep all packaging out of the reach of children as it could constitute a health hazard.



**ATTENTION:
DURING A WASH CYCLE THE WATER
CAN REACH TEMPERATURES OF 90°C.**

Setting up - Installation

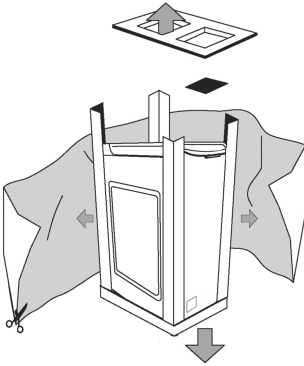

- Unpack the appliance.

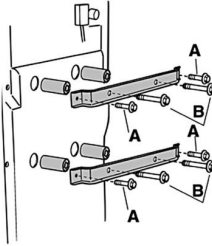

- Remove the 4 screws (A) from both clamps and the 4 screws (B).

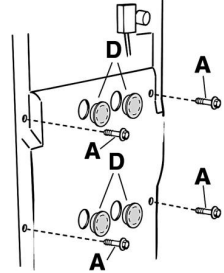

- Replace the 4 screws (A) and fit the trims provided (D).

If your model offers this function:

Position the protection sheet as shown in the diagram.

- 1.- Washing machine with wheel trolley.
- 2.- Washing machine without wheel trolley.

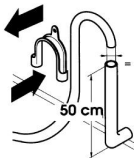
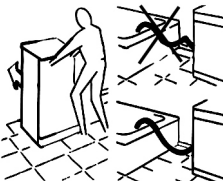
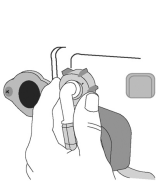
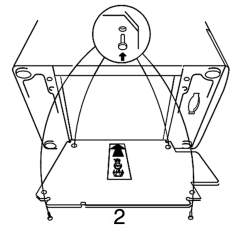
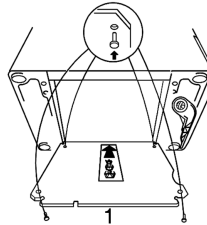

ATTENTION: DO NOT TURN THE TAP ON

- The washing machine should be connected to the water mains via the new tube supplied with the appliance (inside the drum). Do not use the old tube for this purpose.

- Connect one end of the water inlet pipe with the elbow bend to the electrovalve (top rear part of the machine) and the other end to a tap or a plumbed-in 3/4" gas threaded connection.

- Place the washing machine close to the wall, ensuring that there are no bends or kinks anywhere in the tube. Hook the outlet pipe to the edge of the sink or preferably to a fixed drainage outlet of a diameter greater than that of the outlet pipe and at a height of min. 50 cm. and a maximum of 75 cm. from the floor.

If necessary, use the curved accessory to attach and support the outlet pipe more securely.

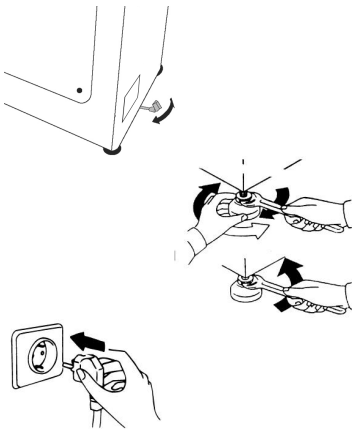

If your model offers this function:

- To move the washing machine easily, turn the trolley lever to the right. Once you have finished moving the machine, return the lever to its original position.
- Level the machine by adjusting the front feet.
 - a) Turn the nut clockwise to release the screw on the foot.
 - b) Raise or lower the foot by rotating it until it stands firmly on the floor.
 - c) Lock the foot in position by turning the nut anticlockwise until it comes up against the bottom of the washing machine.

Check that the appliance is properly levelled.
Check that the washing machine does not rock by trying to move two diagonally opposite top corners at the same time.

- If you move the washing machine from one place to another, you must level the feet again afterwards.
- Connect the machine.

Guarantee



A

1. The appliance is accompanied by a Guarantee Certificate.



2. Complete part **A** and keep it. It must be presented to the Technical Assistance Centre in the event of a repair being necessary, along with the legal receipt issued by the dealer on purchase.

Preparing the wash. Opening/ closing the drum



ATTENTION:

IT IS IMPORTANT TO MAKE SURE THAT THE DRUM IS CAREFULLY OPENED AND CLOSED, OTHERWISE THE MACHINE OR LAUNDRY COULD GET DAMAGED.

ENSURE THAT THE DOORS FIT TOGETHER PERFECTLY AND ARE PROPERLY CLOSED.

Loading

1.

Open the washing machine lid.

2.

Open the drum by pressing the white button with one hand while pressing down on the opposite door with the other.

3.

Place clothes in the drum one item at a time, and without squashing. Do not exceed the load limits recommended in the "programme table". An overloaded washing machine will not wash properly, and will leave clothing wrinkled.

4.

To close the drum, place the doors so that the one with the white button is below the other and they fit together perfectly.

Detergent load

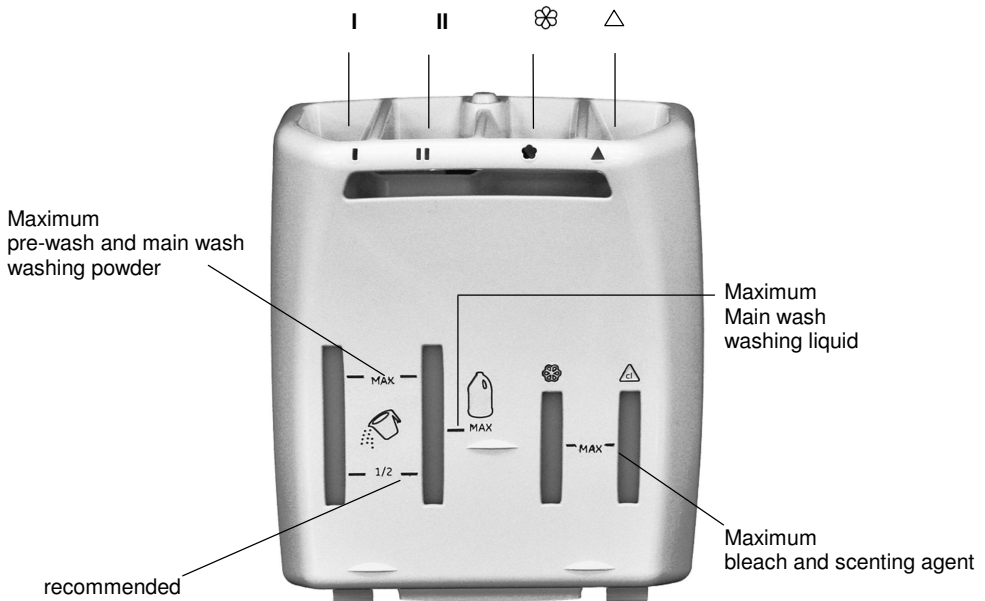

The detergent dispenser is divided into 4 compartments:

- .- **Compartment I** is for the pre-wash detergent.
- .- **Compartment II** is for the main wash detergent.
- .- The **compartment** △ is for bleach.
- .- The **compartment** ☼ is for fabric conditioners, scenting agents and special additives such as starch, blueing, etc.

The detergent dispenser has two reference marks:

- .- **Recommended** (lower reference mark). This indicates the recommended level for the pre-wash and main wash compartments.
- .- **Max**. This indicates the maximum level, which should never be exceeded.

Important:

- We recommend not using bleach for programs with a prewash cycle.
- Do not use liquid detergent for programs with a prewash cycle and/or timed start.

Electronically- controlled Variable Load – Fuzzy Logic

This machine has electronics that automatically process all stages of the wash to ensure exceptional results and at the same time save you time and money.

Once a programme has been selected, the machine **optimises the following elements depending on the wash load and type of fabric:**

- quantity of water and power consumption
- wash time
- rinse efficiency

The washing machine also:

- detects suds and increases the amount of rinse water if necessary
- adjusts spin speed according to load distribution, thus forestalling any imbalance in the mechanism.

Specific / special programmes



SPECIAL RINSE PROGRAMME

Programme  runs 3 rinses with spins at 800 rpm (this speed may be reduced or spin cancelled using the appropriate button). It works for all fabrics and can be used, e.g. after garments are hand washed.



SPECIAL HIGH-SPEED SPIN PROGRAMME

Programme  runs a spin at the speed indicated in the programme table.



EMPTY ONLY

Programme  empties the water from the machine.



HAND WASH

The washing machine also has a delicate washing cycle called "hand wash". The programme runs a complete wash cycle for garments intended to be hand washed. It washes at no more than 30 °C and finishes with three rinses and a delicate spin.

SPORT

SPORTSWEAR

The machine has an exclusive programme for sportswear. It is intended for mixed sportswear which should not be washed with high-temperature programmes. It begins with a cold pre-wash to soften and eliminate the worst of the dirt, then runs a 30 °C wash, a rinse and a delicate spin to ensure maximum care for delicate, heavily soiled garments.

AA

CLASS AA

Optimum wash performance can be obtained at 40 °C with Class A power consumption.

A

CLASS A

It is possible to obtain an optimum wash performance with a maximum load of 3 kg at a temperature of 60 degrees C with a considerable reduction in time.

MIX & WASH

MIX & WASH

The MIX & WASH programme allows different types of fabric to be washed at the same time.

- new coloured garments must be washed separately the first time.
- never mix non-fast coloureds.

EXPRESS PROGRAMMES

EXPRESS

44' MINUTE EXPRESS PROGRAMME

29' MINUTE EXPRESS PROGRAMME

32' MINUTE EXPRESS PROGRAMME

These programmes run a complete wash cycle at 40/50 °C for up to 3.5 kg of washing in 44/32 or 29 minutes.

REMARKS

1. For heavily soiled washing we recommend loads of no more than 3 kg.
2. Bleach can be added via dispenser (△) for the WHITE 90° and FAST COLOUR 60° COTTONS programmes.
3. The machine is designed to apply fabric softener automatically in the last rinse of all wash cycles.

CLEANING AND MAINTENANCE OF THE MACHINE

Do not use abrasives, spirits or solvents when cleaning the exterior of the washing machine. It is sufficient to use a damp cloth.

The washing machine requires very little maintenance.

- Drying the rubber seal of the drum.
- Cleaning the dispenser and its compartments.
- Cleaning the filter.
- Cleaning prior to removals or when the machine is to stand idle for long periods.

To help conserve the washing machine, dry the rubber seal and leave the door open when the cycle ends.

CLEANING THE FILTER

The washing machine comes with a special filter, located behind the machine's front plinth panel, that collects larger objects (coins, buttons, etc.) which could even block the pump.

It is advisable to clean the filter whenever the machine fails to rinse the clothes as well as it should or when it fails to drain properly.

When it is necessary to clean the filter, proceed as follows:

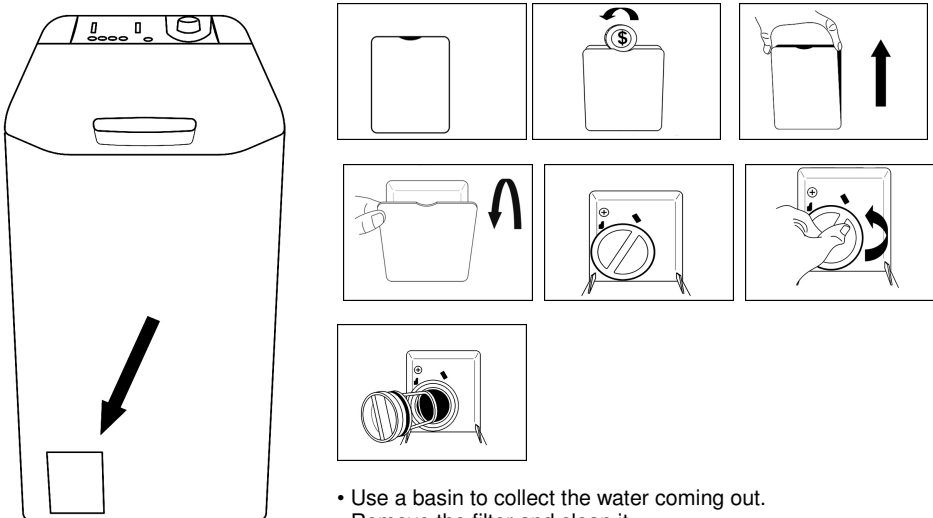

- Use a basin to collect the water coming out.
- Remove the filter and clean it.
- Once the filter is clean, replace it by following the above-mentioned procedure in reverse.

CLEANING THE DETERGENT DISPENSER AND ITS COMPARTMENTS



.- It is advisable to clean the four compartments of the detergent dispenser (pre-wash, wash, bleach and fabric conditioner) from time to time. To do this, remove the detergent dispenser and after cleaning it, fit it back in place.

To remove and fit the detergent dispenser, follow the steps indicated in the images.

A removing



.- Press button A



.- Hold down the button and turn the detergent dispenser outwards



.- Remove the dispenser and clean it

.- In the case of the pre-wash (I) and wash (II) compartments, it is advisable to remove any dried-in remains of detergent which obstruct the flow of the detergent to the drum.

S

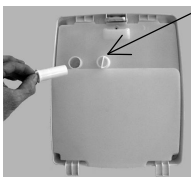

.- In the case of the bleach and fabric conditioner compartments, the two traps (S) located at the rear part of the dispenser should be removed by pulling them out. Remove any solid residue which could block the holes in the compartments.

B



fitting

.- Fit in the tabs as shown

C



.- Turn the detergent dispenser towards the housing (C) in the door until the tab clicks into place.

Troubleshooting

| FAULT | CAUSE | SOLUTION |
|--|---|--|
| 1.- No programme works | <ul style="list-style-type: none"> • The appliance is not plugged in. • The general switch is disconnected. • There is no electricity. • The fuses in the electric installation are damaged. • The door is open. | <ul style="list-style-type: none"> • Plug it in. • Activate the general switch. • Check. • Check. • Close the door. |
| 2.- The appliance does not load water | <ul style="list-style-type: none"> • See causes for 1. • The tap is turned off. | <ul style="list-style-type: none"> • Check. • Turn on the tap. |
| 3.- The water does not drain | <ul style="list-style-type: none"> • The filter is clogged. • The outlet pipe is bent. | <ul style="list-style-type: none"> • Check the filter. • Straighten the outlet pipe. |
| 4.- The spin function does not work | <ul style="list-style-type: none"> • The washing machine has not yet drained the water. • The "Spin Exclusion" option is activated. | <ul style="list-style-type: none"> • Wait a few minutes for the washing machine to drain. • Enable the spin option. |
| 5.- Strong vibrations during spin cycle | <ul style="list-style-type: none"> • The washing machine is not correctly levelled. • The anchoring device for transport has not been removed. • The wash load is not evenly distributed. | <ul style="list-style-type: none"> • Adjust the feet. • Remove the transport support. • Distribute it evenly. |
| 6.- The high-speed spin does not work | <ul style="list-style-type: none"> • The wash load is not evenly distributed within the drum. | <ul style="list-style-type: none"> • Distribute the wash load evenly in the drum. |

If the problem or malfunctioning persists, disconnect the machine, turn off the tap and do not try to repair.

For all repairs contact an Official Technical Assistance centre (consult the European guarantee sheet) and always insist on the use of original parts. Failure to do so may compromise the safety of your machine.

When contacting a Technical Assistance Centre always refer to the model (see also control panel) and the registration and serial numbers indicated on the plate at the bottom front of the machine behind the plinth panel or on the guarantee certificate. That is to say, everything that appears in the box.

Providing this information will ensure a faster and more efficient service.

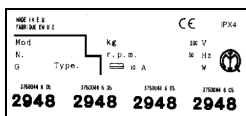

Washing hints

Hints on the most economical, most environmentally friendly way to use your washing machine.

HINTS ON USING YOUR WASHING MACHINE

Wait until you have a full load before using the machine: this will avoid the use of more water and power than necessary.

We recommend using the full load capacity: this could save you up to 50% in power consumption. Wash a single full load rather than two light loads.

WHEN IS PRE-WASHING NECESSARY?

Only when washing heavily soiled clothes.

With clothes that are not especially dirty, you can save between 5 and 15% by not using this option.

WHAT WASH TEMPERATURE SHOULD I USE?

Applying a stain remover before placing clothes in the machine will eliminate the need for wash temperatures of more than 60 °C.

When loading a wash into the drum, we recommend that you:

• **For specially delicate garments we recommend the use of a protective net.**

- Empty all pockets and ensure that they do not contain metal objects (paperclips, safety pins, pins, coins, etc.).
- Fasten pillow slips, close all zips and fastenings, and tie any loose ribbons or belts from dresses.
- Remove all runners (metal and plastic) from curtains and net curtains. We recommend that the ribbon be gathered into a ball and tied with its own cord.
- Unfold all items to be washed.
- Be careful not to exceed the recommended load for each programme.
- When washing rugs, bedspreads and other highly absorbent items, cancel the spin option.
- In order to be able to wash woollens in the washing machine they must carry the "Pure New Wool"  symbol as well as the information "does not become matted" or "machine washable".
- If possible, do not wash only towels. Mix them with your regular washing.
- Ensure that no item becomes trapped between the drum doors.

LABEL SYMBOLS

Labels are usually sewn into the collar or side seams. The symbols which appear on them indicate the following:

- Maximum WASH temperature.
- Appropriate and inappropriate washing methods.
- Appropriate and inappropriate washing products.

The symbols are as follows:

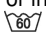

WASH

Washing instructions always appear as a basin with different indications:

- Do not wash. 
- Can be washed both by hand or in the washing machine. The figures in the basin indicate the maximum wash temperature. 



- Hand wash only. 

When the hand is half submerged in the water, this means that the item should be tumbled only gently during washing. If it is fully submerged in the water, this means that the garment should only be washed by hand.

- The line under the basin means that the item should be washed on a gentle cycle. 
- Do not spin. 

BLEACH

Bleach is widely used to whiten fabrics, although in some cases it can cause irreparable damage. There are various symbols which refer to its use.

- Bleach can be used. 
- Do not use bleach. 

WEEE



This appliance is marked according to the European directive 2002/96/EC on Waste Electrical and Electronic Equipment (WEEE).

By ensuring this product is disposed of correctly, you will help prevent potential negative consequences for the environment and human health, which could otherwise be caused by inappropriate waste handling of this product.

The symbol on the product indicates that this product may not be treated as household waste. Instead it shall be handed over to the applicable collection point for the recycling of electrical and electronic equipment

Disposal must be carried out in accordance with local environmental regulations for waste disposal.

For more detailed information about treatment, recovery and recycling of this product, please contact your local city office, your household waste disposal service or the shop where you purchased the product.

EN The manufacturer declines all responsibility in the event of any printing mistakes in this booklet. The manufacturer also reserves the right to make appropriate modifications to its products without changing the essential characteristics.

