



HOOVER

INSTRUCTION MANUAL



GENERATION FUTURE

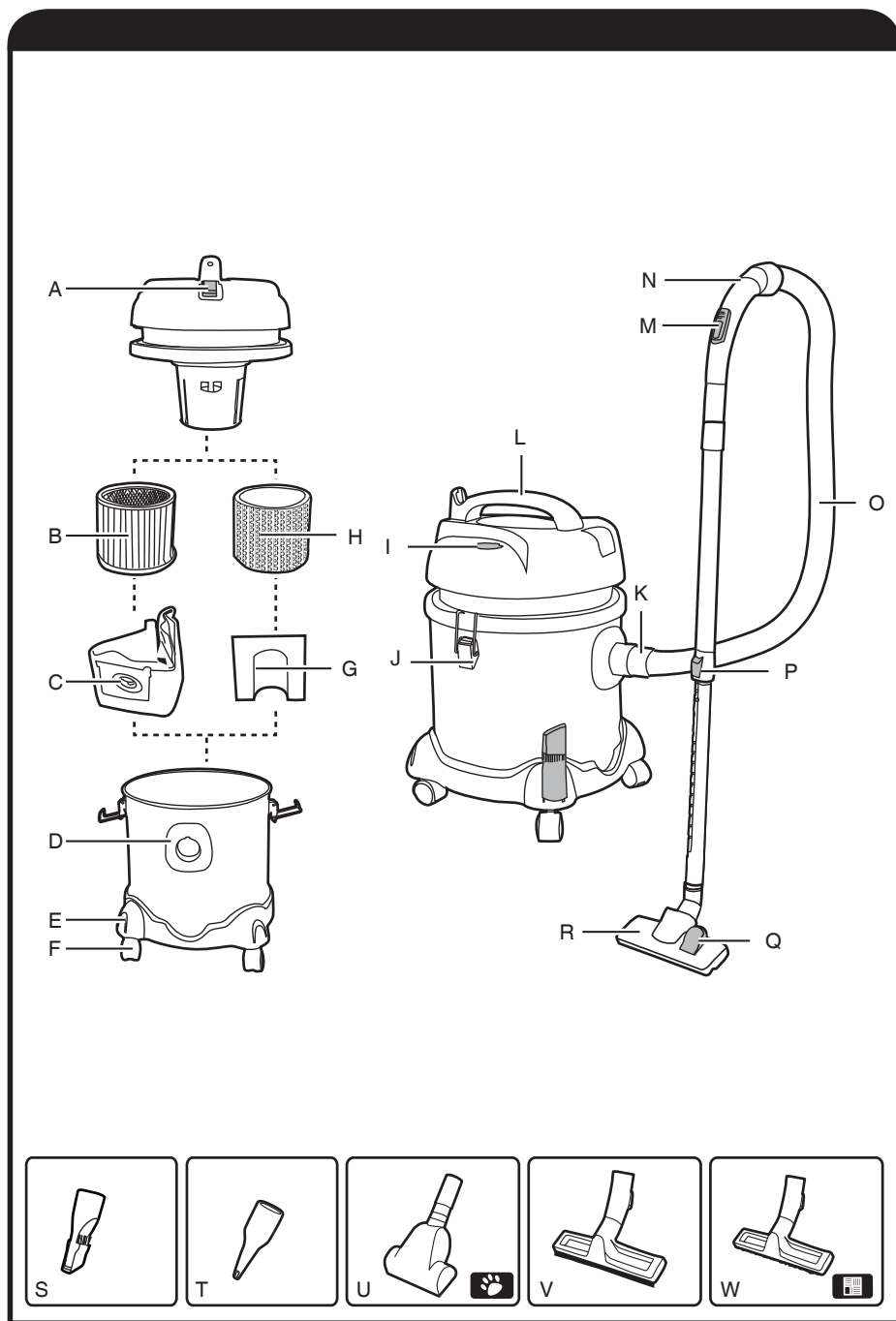

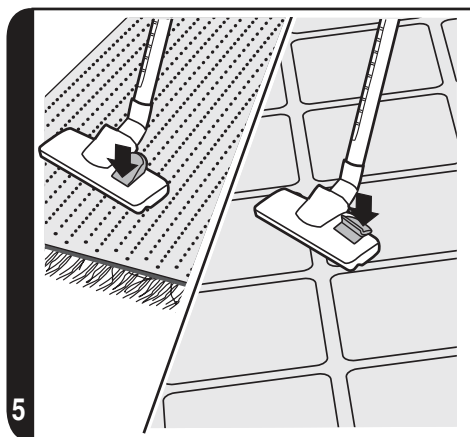
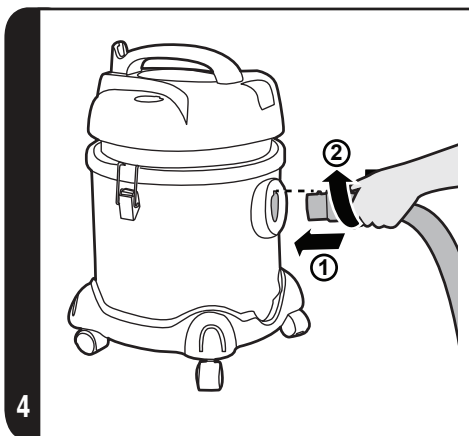
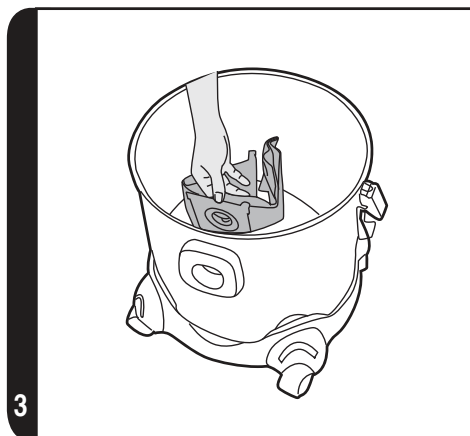
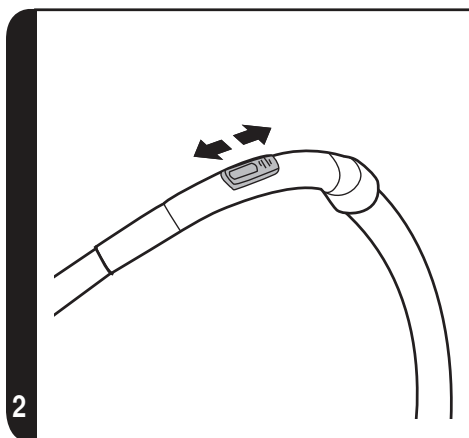
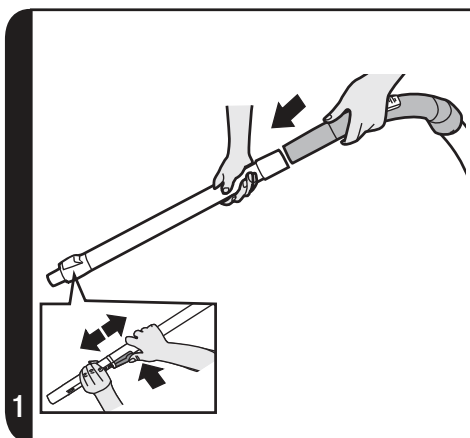

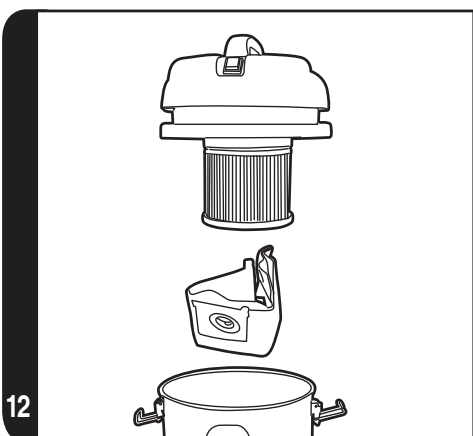
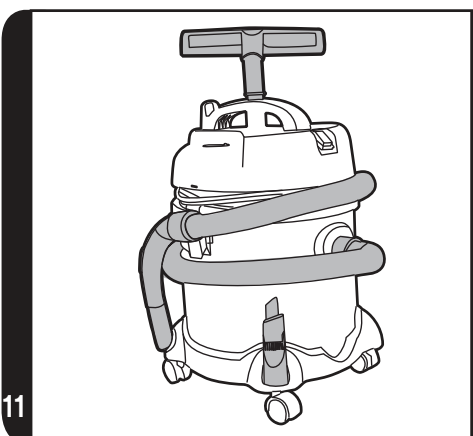
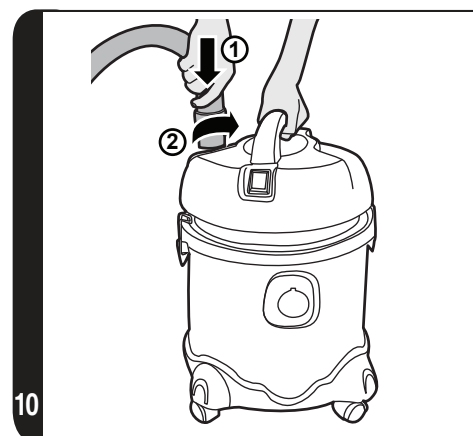
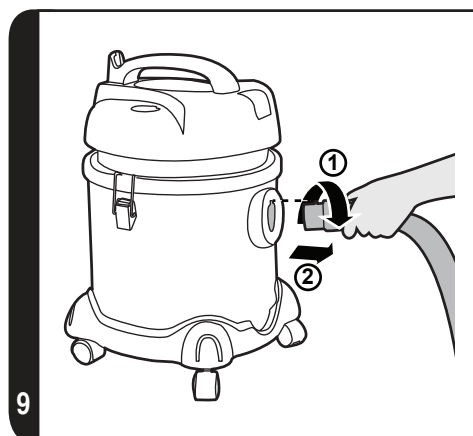
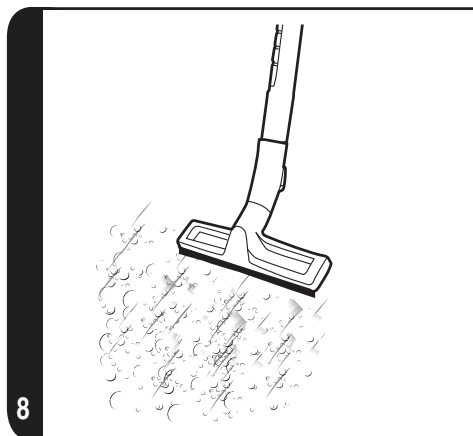
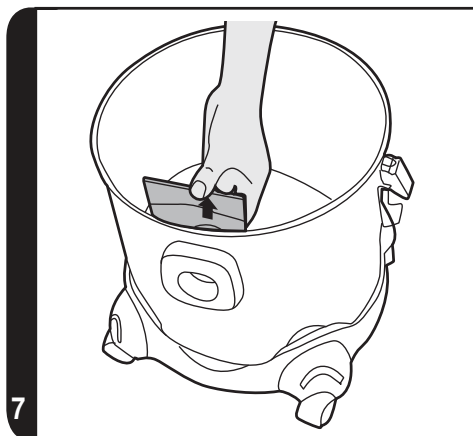



13



14

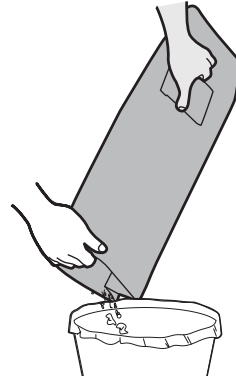

15

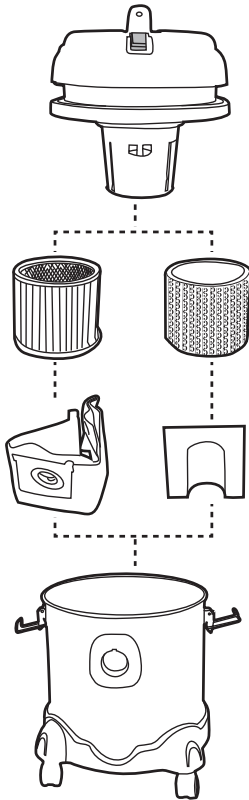

16

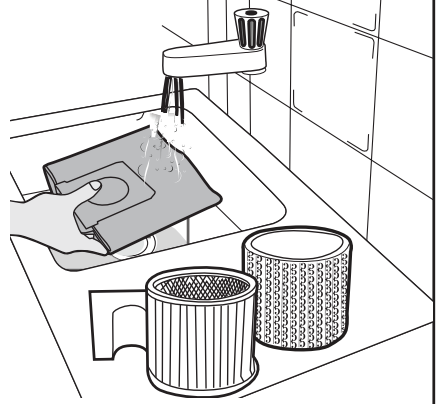

17





IMPORTANT SAFETY REMINDERS

This appliance should only be used, as described in this user guide. Please ensure that this guide is fully understood before operating the appliance.

Do not leave the appliance plugged in. Always switch off and remove the plug from the socket after use, or before cleaning the appliance or any maintenance task.

This appliance can be used by children aged from 8 years and above and persons with reduced physical, sensory or mental capabilities or lack of experience and knowledge if they have been given supervision or instruction concerning use of the appliance in a safe way and understand the hazards involved. Children shall not play with the appliance. Cleaning and user maintenance shall not be made by children without supervision.

If the power cord is damaged stop using the appliance immediately. To avoid a safety hazard, an authorised Hoover service engineer must replace the power cord.

Keep hands, feet, loose clothing and hair away from rotating brushes.

Use only attachments, consumables or spares recommended or supplied by Hoover.

Static electricity: Some carpets can cause a small build up of static electricity. Any static discharge is not hazardous to health.

Do not use your appliance out of doors.

Do not pick up hard or sharp objects, matches, hot ashes, cigarette ends or other similar items.

Do not spray with or pick up flammable liquids, cleaning fluids, aerosols or their vapours.

Do not run over the power cord when using your appliance or remove the plug by pulling on the power cord.

Do not continue to use your appliance if it appears faulty.



GB

Level of noise : ≤ 84 dB(A)

This appliances is suitable for home use, not for commercial use.

Hoover service: To ensure the continued safe and efficient operation of this appliance we recommend that any servicing or repairs are only carried out by an authorised Hoover service engineer.

Do not stand on or wrap the cord around arms or legs when using your appliance.

Do not use the appliance to clean animals or people.

Do not position the appliance above you when cleaning the stairs.

Do not touch the plug or appliance with wet hands.

GETTING TO KNOW YOUR CLEANER

- A. On/Off switch
- B. Pre-motor filter
- C. Dust Bag
- D. Hose Inlet
- E. Tank Base
- F. Castor Wheel
- G. Dam Board
- H. Sponge
- I. Blower Outlet
- J. Securing Latches
- K. Hose End
- L. Carry Handle
- M. Suction Regulator
- N. Hose Handle
- O. Hose
- P. Telescopic Tube Adjuster
- Q. Floor type selector
- R. Carpet & Floor Nozzle
- S. Crevice Tool
- T. Inflator
- U. Mini Turbo Nozzle
- V. Wet Nozzle
- W. Easy Parquet Nozzle



ASSEMBLING YOUR CLEANER

Remove all components from the packaging.

1. Release the securing latches to access the tank and take all components out.
2. Turn the tank upside down and attach the castors into the holes.

USING YOUR CLEANER

1. Ensure the product is correctly assembled together with the securing latches.
2. Connect the hose handle with telescopic tube. [1]
3. Assemble the accessories you require for the specific task.
4. The product is operated by switching the on/off switch.
5. To adjust the performance the suction regulator can be adjusted: [2]
Suction regulator open = reduced performance
Suction regulator closed = maximum performance

DRY VACUUMING

NOTE: After wet vacuuming, the appliance must be absolutely dry.

1. Ensure the pre-motor filter is fitted correctly. **Never dry vacuum without filters or with damaged filters.**
2. Remove the dam board and replace with a dust bag, ensure the dust bag is fitted correctly. [3]
3. Insert the hose end into the hose inlet, rotate the hose end clockwise until locked, and connect the Carpet & Floor nozzle with the tube. [4]
4. Press the floor type selector on the nozzle [5] to select the ideal cleaning mode for the floor type.
5. When the product loses suction, stop vacuuming and check the bag. Replace it if necessary. A dust bag is essential when vacuuming fine dust (i.e. ashes, cement, etc). However it is recommended for normal use as it not only improves the retention of dust, but also protects both the motor and pre-motor filter.

WET VACUUMING

NOTE: Never use a dust bag or pre-motor filter when vacuuming liquids.

1. Release the securing latches, remove the motor top cover and replace the motor filter with the sponge. [6]
2. Remove the dust bag and insert the dam board correctly in position on the main body. [7]
3. Connect the wet nozzle to the tube. [8]
4. When the product float activates and the cleaner loses performance, please stop vacuuming and empty the tank.
5. Prolonged use after this time may cause damage.
6. Always empty, wash and dry the product after use.

NOTE: Ensure that the pre-motor filter is removed and put on sponge when vacuuming liquids.



BLOWER FUNCTION

The cleaner can be used as a blower for leaves, dust, etc.:

1. Switch off cleaner.
2. Release the hose assembly, rotate the hose, anticlockwise until un-locked. [9]
re-connect the hose assembly to the blower outlet ensuring it locks fully into place.[10]
3. Close the suction regulator. [2]
4. Switch the cleaner on by pressing the on/off switch on the cleaner main body.
5. Do not blow towards people or animals.

Parking and Storage Section [11]

1. The tube can be parked on back or on the bottom of the cleaner for storage.
or temporary storage while in use.
2. Crevice tool can be inserted into the base of cleaner.

CLEANER MAINTENANCE

Removing and replacing the dust bag

If the suction is low please check if bag requires to be emptied, cleaned or if necessary replaced.

1. Switch off the cleaner.
2. The hose must be detached from the cleaner prior to the dust bag being removed .
3. Release the securing latches and remove the top cover.[12]
4. Remove the dust bag upwards. [13]

NOTE: Remove the hose assembly before taking out the dust bag.

5. Remove the sealing strip. [13]
6. Empty the dust from the bag and dispose of it correctly and carefully. [14]
7. Wash it in hand warm water [16], and allow it to dry [17].

Cleaning the Filter:

To maintain optimum performance of your cleaner, please wash the pre-motor filter and exhaust filter when suction decreases.

Cleaning the pre-motor filter:

1. Remove the pre-motor filter by rotating it anticlockwise
2. Wash it in hand warm water [16], and allow it to dry [17] thoroughly before replacing to the cleaner

REMEMBER: Do not use hot water or detergents. In the unlikely event of the filters becoming damaged, fit a Genuine Hoover replacement. Do not try and use the product without a dust bag or filter fitted.



GB

ACCESSORIES

Please see the model specification on the packaging label for inclusion of accessories to individual models. All accessories can be purchased separately from Hoover. (See Hoover Spares and Consumable section).

All accessories can be fitted to the end of the hose or the end of the extension tube.

All included accessories, hose and tubes are integrated on the product.

Crevice Tool – For corners and hard to reach areas. [S]

Inflator – For inflating boats, paddling pools etc. [T]

Mini Turbo Nozzle – Use the mini turbo nozzle on stairs or for deep cleaning on textile surfaces and other hard to clean areas [U]

Wet Nozzle – For liquid collection [V]

Easy Parquet Nozzle – For parquet floors and other delicate floors.[W]

NOTE: Remove the hose assembly before taking out the dust bag.

USER CHECKLIST

Should you have a problem with the product, complete this simple user checklist before calling your local Hoover service.

- Is there a working electricity supply to the cleaner? Please check with another electrical appliance.
- Is the bag / container full? Please check the product.
- Is the dust bag over-filled? Please refer to 'Cleaner Maintenance'.

IMPORTANT INFORMATION

Hoover Consumables and Spares

Always replace parts with genuine Hoover spares. These are available from your local Hoover dealer or direct from Hoover. When ordering parts always quote your model number.

Consumables:

- | | | |
|-------------------------------|-------|----------|
| • Cloth Bag | CA68C | 35601590 |
| • Kit Pre-Motor Filter & Foam | U73 | 35601585 |

Spares

- | | | |
|-------------------------|------|----------|
| • Hose Handle Assy | D149 | 35601586 |
| • Carpet & Floor Nozzle | G153 | 35601588 |
| • Easy Parquet Nozzle | G152 | 35601587 |
| • Wet Nozzle | G154 | 35601589 |

**GB**

Hoover Service

Should you require service at any time, please contact your local Hoover Service Office.

The Environment

The symbol on this appliance indicates that this appliance may not be treated as household waste. Instead it must be handed over to the applicable collection point for the recycling of electrical and electronic equipment. Disposal must be carried out in accordance with local environmental regulations for waste disposal. For more detailed information about treatment, recovery and recycling of this appliance, please contact your local city office, your household and waste disposal service or the shop where you purchased the appliance.



CE This appliance complies with the European Directives 2006/95/EC, 2004/108/EC and 2011/65/EU.

HOOVER Limited, Pentrebach, Merthyr Tydfil, Mid Glamorgan, CF48 4TU, UK

Your Guarantee

The guarantee conditions for this appliance are as defined by our representative in the country in which it is sold. Details regarding these conditions can be obtained from the dealer from whom the appliance was purchased. The bill of sale or receipt must be produced when making any claim under the terms of this guarantee.

Subject to change without notice.



GENERATION FUTURE

Hoover Limited Pentrebach
Merthyr Tydfil
Mid Glamorgan
CF48 4TU

Hoover Customer Helpine
03444 995599

PRINTED IN P.R.C.
48018111