

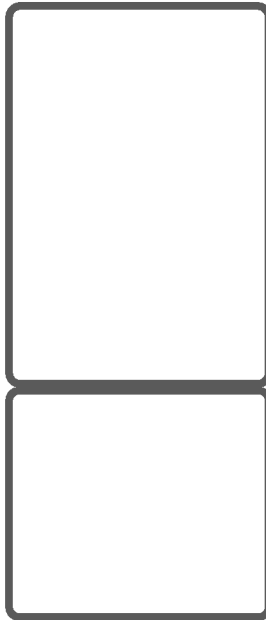

USER MANUAL

**COMBI**



# **SUMMARY**

## SAFETY INFORMATION

### COMBI REFRIGERATOR HOOVER

Climate Class

## TRANSPORTATION INSTRUCTIONS

## INSTALLATION INSTRUCTIONS

## STARTING TO USE

## COMBI OPERATION

VERTICAL DISPLAY

TOP FEATURED VERTICAL DISPLAY

INTERNAL USER INTERFACE

## TECHNICAL FEATURES

HUMIDITY EQUALISER

ANTIBACTERIAL SYSTEM (if present)

WATER DISPENSER

Tips for keeping food perfect in the Fridge

Where to store your foods in the fridge

Storing Frozen Food

## ENERGY SAVING

## TAKE CARE

Defrosting

Cleaning and Care

## CHANGING THE INTERNAL LIGHT

## REVERSING THE DOOR SWING

## TROUBLE SHOOTING

Thank you for purchasing this product.

Before using your refrigerator, please carefully read this instruction manual in order to maximize its performance. Store all documentation for subsequent use or for other owners. This product is intended solely for household use or similar applications such as:

- the kitchen area for personnel in shops, offices and other working environments
- on farms, by clientele of hotels, motels and other environments of a residential type
- at bed and breakfasts (B & B)
- for catering services and similar applications not for retail sale.

This appliance must be used only for purposes of storage of food, any other use is considered dangerous and the manufacturer will not be responsible for any omissions. Also, it is recommended that you take note of the warranty conditions.

## **SAFETY INFORMATION**

Please read the operating and installation instructions carefully!

They contain important information on how to install, use and maintain the appliance.

The manufacturer is not liable if you fail to comply with the instructions and warnings.

Retain all documents for subsequent use or for the next owner.

- **Do not connect the appliance to the electricity supply until all packing and transit protectors have been removed. Keep children away from packaging and its parts. Danger of suffocation from folding cartons and plastic film!**
- **Leave to stand for at least 4 hours before switching on the product, to allow compressor oil to settle if transported horizontally.**
- **Make sure there is no transport damage.**
- **Do not damage the refrigerant circuit.**
- **Maintain the ventilation openings in the appliance enclosure or in the built-in**

**structure, free of obstruction.**

- **Never use water to wash the compressor position, wipe it with a dry cloth thoroughly after cleaning to prevent rust.**
- **Handle the appliance always with at least two persons because it is heavy.**
- **Install and level the appliance in an area suitable for its size and use.**
- **Make sure that the electrical information on the rating plate agrees with the power supply. If it does not, contact an electrician.**
- **The appliance is operated by a 220-240 VAC/50 Hz power supply. Abnormal voltage fluctuation may cause the appliance to fail to start, or damage to the temperature control or compressor, or there may be an abnormal noise when operating. In such case, an automatic regulator shall be mounted.**
- **Only for UK: The appliance's power cable is fitted with 3-cord (grounding) plug that fits a standard 3-cord (grounded) socket. Never cut off or dismount the third pin (grounding). After the appliance is installed, the plug should be accessible.**
- **Make sure that mains cable is not caught under the appliance during and after carrying/moving the appliance, to avoid the mains cable becoming cut or damaged. If the**

**supply cord is damaged, it must be replaced by the manufacturer, its service agent or similarly qualified person in order to avoid a hazard.**

- **Do not install the appliance in humid, oily or dusty places, nor expose it to direct sunlight and to water.**
- **Do not install the appliance near heaters or inflammable materials.**
- **FOR appliances with a freezer compartment: if there is a power failure do not open the lid. Frozen food should not be affected if the failure lasts for less than the hours indicated on the rating label (Temperature rise time). If the failure is longer, then the food should be checked and eaten immediately or cooked and then refrozen.**
- **If you find that the lid of the appliance is difficult to open just after you have closed it, don't worry. This is due to the pressure difference which will equalize and allow the lid to be opened normally after a few minutes.**
- **Do not store medicines, bacteria or chemical agents in the appliance. This appliance is a household appliance, it is not recommended to store materials that require strict temperatures.**

- **Do not excessively pull or fold the power cord or touch the plug with wet hands.**
- **Do not store products which contain flammable propellant (e.g. spray cans) or explosive substances in the appliance. Risk of explosion!**
- **Do not place unstable articles (heavy objects, containers filled with water) on top of the refrigerator, to avoid personal injury caused by falling or electric shock caused by contact with water.**
- **Do not use electrical appliances inside the food storage compartments, unless they are of the type recommended by the manufacturer.**
- **Do not touch internal cooling elements, especially with wet hands, to avoid cracks or injuries.**
- **At risk here are children, people who have limited physical, mental or sensory abilities, as well as people who have inadequate knowledge concerning safe operation of the appliance.**
- **Check that children and vulnerable people have understood the hazards. A person responsible for safety must supervise or instruct children and vulnerable people who are using the appliance. Only children aged 8**

**years and above may use the appliance.**

- **Children should not play with the appliance.**
- **Children aged from 3 to 8 years are allowed to load and unload this appliance.**
- **FOR appliances with a freezer compartment: do not store bottled or canned liquids (especially carbonated drinks) in the freezer compartment. Bottles and cans may burst!**
- **FOR appliances with a freezer compartment: never put frozen food straight from the freezer compartment in your mouth. Risk of low-temperature burns!**
- **Keep plastic parts and the door seal free of oil and grease. Otherwise, plastic parts and the door seal will become porous.**
- **Before performing any operation, unplug the power cord from the power socket.**
- **Do not use mechanical devices or other means to accelerate the defrosting process, other than those recommended by the manufacturer.**
- **Do not use pointed or sharp-edged objects such as knives or forks to remove the frost.**
- **Never use hairdryers, electrical heaters or other such electrical appliances for defrosting.**
- **It is recommended to keep the plug clean, any excessive dust residues on the plug can**

be the cause fire.

- **Do not try to repair, disassemble or modify the appliance by yourself. In case of repair please contact always our customer service.**
- **Supervise children while the appliance is being cleaned or maintained.**
- **Do not clean the cold glass shelves with hot water. Sudden temperature change may cause the glass to break.**
- **WARNING: The tubes of the refrigeration circuit convey a small quantity of an environmentally friendly but flammable refrigerant (R600a) and insulating gas (cyclopentane). It does not damage the ozone layer and does not increase the greenhouse effect. If refrigerant escapes, it may injure your eyes or ignite.**
- **If the refrigerant circuit should be damaged:**
  - **Switch off the appliance and pull out the mains plug,**
  - **Keep naked flames and/or ignition sources away from the appliance,**
  - **Thoroughly ventilate the room for several minutes,**
  - **Inform customer service.**
- **WARNING: Do not damage the plug and/or the power cord; this could cause electrical shocks or fires.**



- **WARNING: Do not use multiple portable socket-outlets or portable power supplies. We do not recommend the use of extension leads and multi-way adapters.**
- **Do not attempt to sit or stand on the top of the appliance. You could injure yourself or damage it. This appliance is not designed for stacking with any other ones.**
- **The product is designed and built for domestic household use only.**
- **Only original parts supplied by the manufacturer may be used. The manufacturer guarantees that only these parts satisfy the safety requirements.**
- **Opening the door for long periods can cause a significant increase of the temperature in the compartments of the appliance.**
  - Clean regularly surfaces that can come in contact with food and accessible drainage systems.**
  - Clean water tanks if they have not been used for 48h; flush the water system connected to a water supply if water has not been drawn for 5 days.**
  - Store raw meat and fish in suitable containers in the refrigerator, so that it is not in contact with or drip onto other food.**
  - Two-star frozen-food compartments(if they**

are presented in the appliance) are suitable for storing pre-frozen food, storing or making ice-cream and making ice cubes.

-One-, two- and three -star compartments, if present in the appliance, are not suitable for the freezing of fresh food.

-If the appliance is left empty for long periods, switch off, defrost, clean, dry and leave the door open to prevent mould developing within the appliance.

- FOR Wine Coolers: this appliance is intended to be used exclusively for the storage of wine
- FOR a free standing appliance: this refrigerating appliance is not intended to be used as a built-in appliance
- FOR appliances without a 4-star compartment: this refrigerating appliance is not suitable for freezing foodstuffs
- FOR appliances without a 4-star compartment: this refrigerating appliance is not suitable for freezing foodstuffs”
- FOR a free standing appliance: this refrigerating appliance is not intended to be used as a built-in appliance”
- FOR Wine Coolers: this appliance is intended to be used exclusively for the storage of wine

# COMBI REFRIGERATOR HOOVER

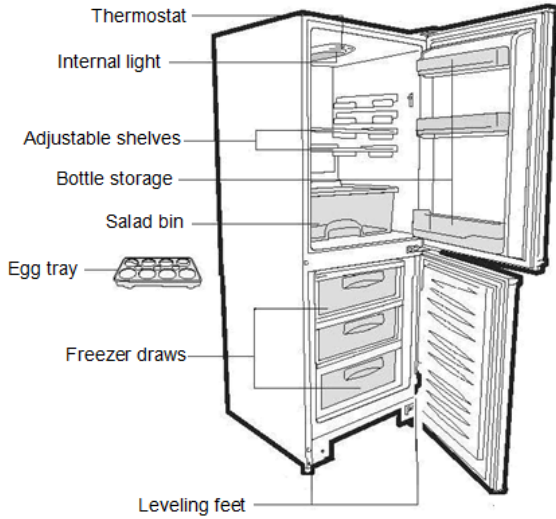

The pictures are for illustrative purposes only.

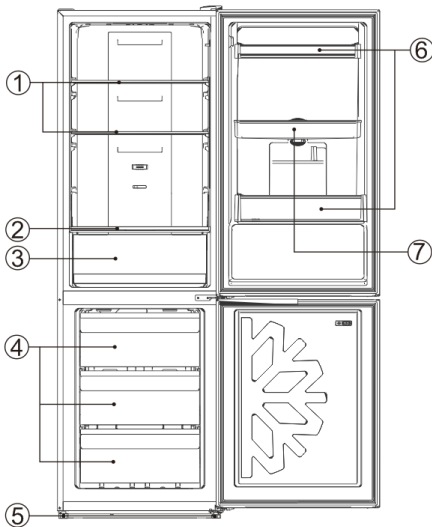

No	Description
1	Fridge shelves
2	Crisper Cover
3	Crisper
4	Freezer drawers
5	Adjustable Feet
6	Refrigerator door racks
7	Water tank assembly

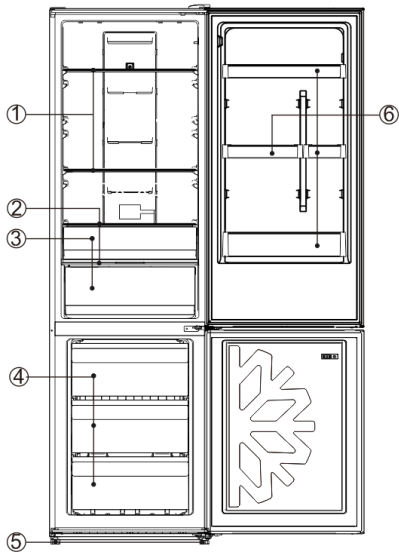

No	Description
1	Fridge shelves
2	Crispercover
3	Vegetable and fruit crisper
4	Freezing drawers
5	Leveling feet
6	Door balcony

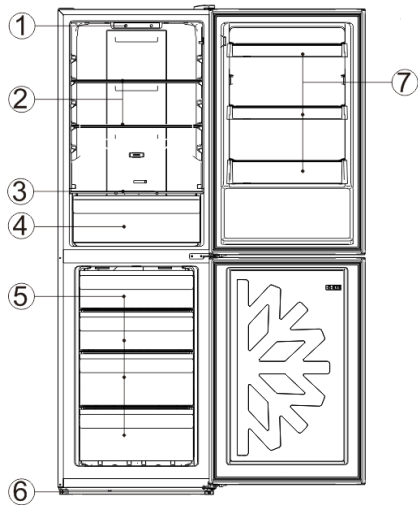

No	Description
1	Control panel
2	Fridge shelves
3	Crisper Cover
4	Crisper
5	Freezer drawers
6	Adjustable Feet
7	Refrigerator door racks

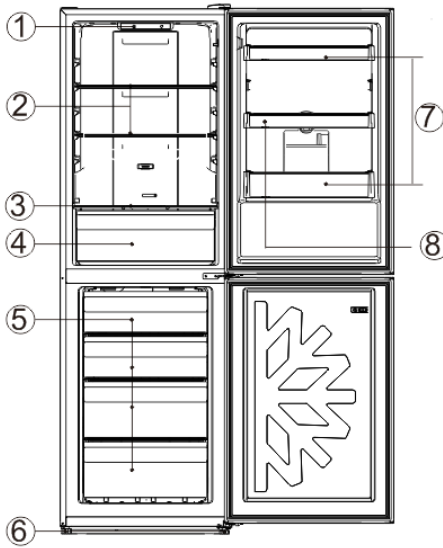

No	Description
1	Control panel
2	Fridge shelves
3	Crisper Cover
4	Crisper
5	Freezer drawers
6	Adjustable Feet
7	Refrigerator door racks
8	Water tank assembly

The most energy-saving configuration requires drawers, food box and shelves to be positioned in the product, please refer to the above pictures.

### Climate Class

The appliance is designed to operate at the limited range of ambient temperature, depending on climate zones. Do not use the appliance at the temperature out of the limit. Climate class of your appliance is indicated on the label with technical description inside the fridge compartment.

Climate Class	Amb. T. (°C)	Amb. T. (°F)
SN	From 10 to 32	From 50 to 90
N	From 16 to 32	From 61 to 90
ST	From 16 to 38	From 61 to 100
T	From 16 to 43	From 61 to 110

- extended temperate (SN): ‘this refrigerating appliance is intended to be used at ambient temperatures ranging from 10 ° C to 32 ° C’ ;
- temperate (N): ‘this refrigerating appliance is intended to be used at ambient temperatures ranging from 16 ° C to 32 ° C’ ;
- subtropical (ST): ‘this refrigerating appliance is intended to be used at ambient temperatures ranging from 16 ° C to 38 ° C’ ;
- tropical (T): ‘this refrigerating appliance is intended to be used at ambient temperatures ranging from 16 ° C to 43 ° C’ ;

## TRANSPORTATION INSTRUCTIONS

The appliance should be transported only in a vertical upright position. The packing as supplied must be intact during transportation. If during the course of transport the product has been transported horizontally, it must only be laid on its left hand side (when facing the door front) and it must not be operated for at least 4 hours to allow the system to settle after the appliance is brought back to upright position.

1. Failure to comply with the above instructions could result in damage occurring to the appliance. The manufacturer will not be held responsible if these instructions are disregarded.
2. The appliance must be protected against rain, moisture and other atmospheric influences.

## INSTALLATION INSTRUCTIONS

1. If possible avoid placing the appliance near cookers, radiators or in direct sunlight as this will cause the compressor to run for long periods. If installed next to a source of heat or refrigerator, maintain the following minimum side clearances:

---

From Cookers	4" (100 mm)
From Radiators	12" (300 mm)
From Fridges	4" (100 mm)

---

2. Make sure that sufficient room, with an average temperature of between 16°C and 32°C, is provided around the appliance to ensure free air circulation. Ideally, a space of no less than 9cm on the back and 2cm on the sides.
3. The appliance should be located on a smooth surface.
4. It is forbidden to use the refrigerator outdoors.
5. Protection from moisture. Do not locate the freezer in moist space to avoid the metal parts rusty. And do not spray water to the freezer, otherwise it will weaken the insulation and causes current leakage.
6. Refer to "Cleaning and Care" section to prepare your appliance for use.
7. If the freezer is installed in unheated areas, garages etc., in cold weather condensation may form on the outer surfaces. This is quite normal and is not a fault. Remove the condensation by wiping with a dry cloth.
8. Never place Refrigerator in a wall recessed or into fitted cabinets or furniture when it is working, the grille at the back may become hot and the sides warm. Do not drape the Refrigerator with any covering.

## STARTING TO USE

Before you starting to use the freezer, please check that:

1. The interior is dry and air can circulate freely at the rear.
2. Clean the interior as recommended under "TAKE CARE" section (electric parts of the refrigerator can only be wiped by dry cloth).
3. Do not switch on until 4 hours after moving the fridge/freezer. The coolant fluid needs time to settle. If the appliance is switched off at any time, wait 30 minutes before

- switching back on to allow the coolant fluid to settle.
4. Before connecting the Refrigerator to the mains supply position. The thermostat control dial is located inside the Fridge compartment.
  5. Turn the thermostat knob to the "3" position and turn on the electricity. The compressor and the light inside the refrigerator will begin to work.
  6. Before storing foods in your refrigerator, turn the refrigerator on and wait for 24 hours, to make sure it is working properly and to allow the Fridge/Freezer to fail to the correct temperature.
  7. Open the door 30 minutes later, if the temperature in the refrigerator decreased obviously, it shows that the refrigerator system works well. When the refrigerator operates for a period of time, the temperature controller will automatically set the temperature within limits it opens.

## COMBI OPERATION

**Appliance connected to power at the first time:** When the appliance is connected to power at the first time, the display will be lit for 2 seconds before going normal and the appliance runs with intelligence function.

**Display Control:** When the refrigerator door is closed and there is no button operation in 3 minutes, the display light goes off.

When the display light is off, open the refrigerator door or click any button to light it up.

### VERTICAL DISPLAY (if present)

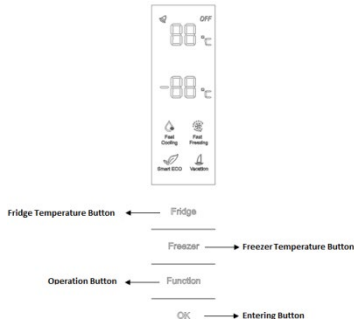

**TEMPERATURE SETTING:** Click the "Fridge" or "Freezer" button and when it flickers in the symbol, temperatures can be set. Each time when the button is clicked, the temperature changes accordingly. Temperatures cannot be set under functions of fast cooling, fast freezing, Smart ECO and vacation. Under temperature setting, if there is no button operation in 5 seconds, the button stops flickering and the set temperature comes into effect.

**SMART ECO:** Activate the Smart Eco button to set the temperatures of the fridge in max. energy efficiency conditions (+4°C for fridge temperature, -18°C for freezer temperature).

*To enter Smart Eco:* Click "option" until it flickers and then click "OK" to enter this function.

*To deactivate Smart Eco:* Click "option" until it goes to Smart ECO, click "OK" to quit this function and the light goes off.

**FAST COOLING:** Activate Fast Cooling mode to start an additional pulse for a fast freezing of the fridge compartment. The function is activated and confirmed by the switching on of the dedicated LED icon.

*To enter Fast Cooling:* Click “option” until it flickers in “Fast Cooling” and then click “OK” to enter this function.

*To deactivate Fast Cooling:* Click “option” until it goes to “fast cooling” and then click “OK” to deactivate this function.

**FAST FREEZING:** Activate Fast Freezing to rapidly freeze big quantities of food keeping intact nutritional food properties. When the light in Fast Freezing goes off and the freezer temperature goes back to the value before fast freezing. When Fast Freezing time is up (26 hours), it deactivates automatically. When it goes to Vacation, Fast Freezing stops.

*To enter Fast Freezing:* Click “option” until it flickers in “Fast Freezing” and then click “OK” to enter this function.

*To deactivate Fast Freezing:* Click “option” until it goes to “fast freezing” and then click “OK” to quit this function.

**VACATION:** In case of long stops, the Vacation function can be used. This function deactivates the fridge compartment, while leaving the freezer on. Ensure that there is no food inside the fridge compartment before using this function. The function is activated and confirmed by the switching on of the dedicated LED icon. The light in Vacation goes off and the refrigerator temperature goes back to the value before Vacation.

Vacation quits under functions of Smart ECO and Fast Cooling.

*To enter Vacation:* Click “option” until it flickers in “Fast Freezing” and then click “OK” to enter this function.

*To deactivate Vacation:* Click “option” until it goes to “Vacation” and then click “OK” to quit this function.

**POWER OFF MEMORY:** Refrigerator can automatically keep all the setting in case of power off. When the unit is plugged in again, the refrigerator will run with the setting before power off.

**POWER-ON DELAY:** To prevent harm to the refrigerator in case of sudden power cut and power on, the unit does not start immediately if the power off time is less than 5 minutes.

**FREEZER OVER-TEMPERATURE ALARM (only in case of power on):** When the freezer temperature is higher than 10°C at the first time connected to power, the symbol light of the freezer chamber goes on and the number representing temperature flickers.

Press any button or wait for 5 seconds, flickering stops and it goes back to the temperature that was set.

**REFRIGERATOR DOOR OPENING ALARM:** When the refrigerator is open over 3 minutes, the buzzer will buzz. Close the door or press any button to stop the alarm, but for the latter, the alarm will go off again after 3 minutes.

**SENSOR FAULT ALARM:** When it shows “E0”, “E1”, “E2” or other abnormal symbols, it means sensor faults and the refrigerator needs repair.



## TOP FEATURD VERTICAL DISPLAY (if present)

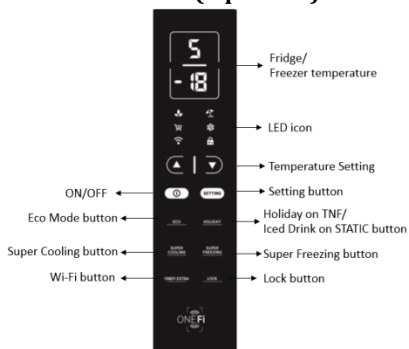

**SETTING Button:** Press "SETTING" to change the temperature.

When button is pressed for the first time: You can change refrigerator temperature with ▲ PLUS Button and ▼ MINUS Button.

When button is pressed for the second time: You can change refrigerator temperature with ▲ PLUS Button and ▼ MINUS Button.

**ON/OFF Button:** To turn on Refrigerator Press ON/OFF button for 3 seconds. To turn off Refrigerator: Press ON/Off button for 3 seconds.

**Stand-by Mode:** To save energy is possible to activate Stanby Mode. The refrigerator will work in normal state and all leds will turn OFF

To enter Stan-by Mode: Press ON/OFF button for 1 second.

To deactivate Stan-by Mode: Press ON/OFF button for 1 second. Fridge back to normal operation.

**ECO MODE Button:** Press Eco Mode button to set temperatures of the fridge in max. energy efficiency conditions (+5°C for fridge temperature, -18°C for freezer temperature). If you want to exit the ECO mode function, you need to press the Eco Mode button again and the refrigerator temperature turns back to normal operation.

**HOLIDAY Button:** In case of long stops, the Holiday function can be used. This function deactivates the fridge compartment, while leaving the freezer on. Ensure that there is no food inside the fridge compartment before using this function. The function is activated and confirmed by the switching on of the dedicated LED icon. If you want to exit the Holiday function, you will need to press the "Holiday" button again, the light in Holiday goes off and the refrigerator temperature goes back to the value before Holiday.

**SUPER COOLING Button:** Press Super Cooling button to start an additional pulse for a fast freezing of the fridge compartment. The function is activated and confirmed by the switching on of the dedicated LED icon.

If you want to exit the Super Cooling function, you need to press the Super Cooling button again and the refrigerator temperature turns back to normal operation.

**SUPER FREEZING Button:** Press Super Freezing button to rapidly freeze big quantities of food keeping intact nutritional food properties. If you want to exit the Super Freezing function, you need to press the Super Freezing button again and the freezer temperature turns back to normal operation.

**WI-FI Button:** This appliance is equipped with OneFi+ technology that allows you to control it remotely via App. Press OneFi+ button to activate Wi-Fi function.

**Machine Enrollment (on App):** Download the Hoover Wizard App on your device. The Hoover Wizard App is available for devices running both Android and iOS, both for tablets and for smartphones. Get all the details of the One Fi+ functions by browsing the App in DEMO mode. Open the App, create the user profile and enroll the appliance following the instructions on the device display or the "Quick Guide" attached on the machine. This operation is necessary just for the first installation. To finalize the enrollment following the instruction on the smartphone's screen.

**Refrigerator usage from remote by App:** When the enrollment is completed, there will be Wi-Fi LED switched on. From now on it will be possible to manage the product by using the buttons on the display or using the App: both of them will be aligned according to the last command given.

**LOCK Button:** Press Lock button to block display user interface (Lock icon enlights, "LO" appears on display and, after 2 seconds, the refrigerator and freezer temperature shows recovery). If you want to exit Lock function, press the "Lock" button again for 3 seconds, and the refrigerator will exit the Lock function.

## INTERNAL USER INTERFACE (if present)



**SET Button:** Press SET button for setting the temperature until you reach the level you want where level 1 is the warmest and level 4 is the coldest. Under normal operating conditions, we recommend using an intermediate setting (level 2).

Once the setting takes effect, it immediately enters the corresponding stall for operation control, and the stall indicator lights up 3s3min and then goes out. Factory default temperature is set to 2. Long press "SET" key to exceed 3s and enter the hardware self-check program. The hardware self-check operation is effective within 10min, and the long button operation after 10min is invalid.

**WI-FI Button:** This appliance is equipped with OneFi+ technology that allows you to control it remotely via App. Press OneFi+ button to activate Wi-Fi function.

**Machine Enrollment (on App):** Download the Hoover Wizard App on your device. The Hoover Wizard App is available for devices running both Android and iOS, both for tablets and for smartphones. Get all the details of the One Fi+ functions by browsing the App in DEMO mode. Open the App, create the user profile and enroll the appliance following the instructions on the device display or the "Quick Guide" attached on the machine. This operation is necessary just for the first installation. To finalize the enrollment following the instruction on the smartphone's screen.

**Refrigerator usage from remote by App:** When the enrollment is completed, there will be Wi-Fi LED switched on. From now on it will be possible to manage the product by using the buttons on the display or using the App: both of them will be aligned according to the last command given.

**FAST COOL Button:** when "FAST COOL" button is pressed, rapid cooling function is activated, according to the 21°C to refrigeration control gear. Maximum running time is 3h, after this time temperature will be set to 1.

If the "SET" button is pressed in the process of speed cooling, the instant cooling function is immediately withdrawn and the default is entered into the next gear.

## TECHNICAL FEATURES

### HUMIDITY EQUALISER (if present)

The exclusive Hoover Humidity Equaliser uses this humidity naturally generated by fruits and vegetables to keep always a level between 85% and 95%.



### ANTIBACTERIAL SYSTEM (if present)

LED UVA Lights activate a Titanium Filter producing a “photocatalysis” reaction which will destroy bacteria within the refrigerator air. This reaction works when the refrigerator door is closed to avoid purified air leakage.



In Total No Frost products, it is inserted in sky box and it works every time the compressor works.

Filter is permanent and therefore does not need changing.

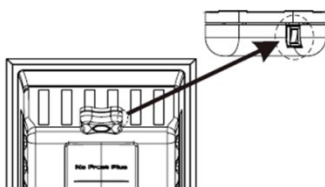

The antibacterial system has to be turned off during the energy consumption test.

### WATER DISPENSER (if present)

The water dispenser allows you to get chilled water without opening the fridge compartment door.

#### **Before first use**

Before using the water dispenser for the first time, remove and clean the water tank located inside the fridge compartment.

- Lift the water tank out of the fridge compartment.
- Open the water tank cover and then clean the water tank and cover in warm soapy water. Rinse thoroughly.
- After cleaning, attach the cover to the water tank and then replace the water tank back on the fridge door.
- Clean the dispenser pad outside the fridge door.

#### **Filling the water tank with water**

- Open the small cover.
- Fill the water tank with drinkable water up to the Max line.
- Close the small cover.



### ***dispensing***

To dispense water, push the dispenser pad gently, using a glass or container. To stop the flow of water, pull your glass away from the dispenser pad.

### **Tips for keeping food perfect in the Fridge**

**Take extra care with meat and fish:** cooked meats should always be stored on a shelf above raw meats to avoid bacterial transfer. Keep raw meats on a plate which is large enough to collect juices and cover it with cling film or foil.

**Leave space around food:** this allows cold air to circulate around the Fridge, ensuring all parts of the Fridge are kept cool.

**Wrap up food!:** to prevent transfer of flavors and drying out, food should be separately packed or covered. Fruit and vegetables need not be wrapped.

**Pre-cooked food should be cooled properly:** allow pre-cooked food to cool down before placing in the Fridge. This will help to stop the internal temperature of the Fridge from rising.

**Shut the door!:** to prevent cold air escaping, try to limit the number of times you open the door. When returning from shopping, sort foods to be kept in your Fridge before opening the door. Only open the door to put food in or take it out.

### **Where to store your foods in the fridge**

**Cool area:** this is where to store foods which will keep longer if they are kept cool. Milk, eggs, yogurt, fruit juices, hard cheeses eg. Cheddar. Opened jars and bottles of salad dressings, sauces and jams. Fats, eg. Butter, margarine, low-fat spreads, cooking fats and lard.

**Coldest area (0°C to 5°C):** this is where foods which must be cold to keep them safe should be kept:

- Raw and uncooked foods should always be wrapped.
- Pre-cooked chilled foods, eg. Ready meals, meat pies, soft cheeses.
- Pre-cooked meats eg. Ham,
- Prepared salads(including pre-packed mixed green salads, rice, potato salad etc).
- Desserts, eg. Fromage frais, home-prepared food and leftovers or cream cakes.

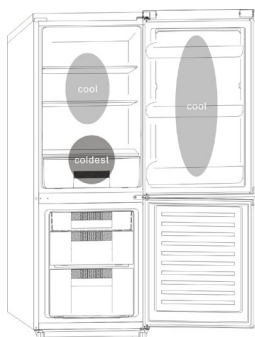

The pictures are for illustrative purposes only.

**Crisper:** this is the most humid part of the Fridge. Vegetables, fruit, fresh salad items eg. Unwashed whole lettuce, whole tomatoes, radishes etc can be stored here.

WE RECOMMEND THAT ALL PRODUCE KEPT IN THE SALAD BIN IS WRAPPED.

**NOTE:** Always wrap and store raw meat, poultry and fish on the lowest shelf at the bottom of the fridge. This will stop them dripping onto, or touching other foods. Do not store inflammable gasses or liquids in the fridge.

Electrical operation after 3h on the freezer, the temperature in the cabinet above -12°C, the alarm light is lit, and buzzer sounds.

### Storing Frozen Food

Prepackaged commercially frozen food should be stored in accordance with the frozen food manufacturer’s instructions for a  freezer compartment.

To ensure that the high quality achieved by the frozen food manufacturer and the food retailer is maintained the following should be remembered:

1. Put packets in the freezer as quickly as possible after purchase.
2. Do not exceed “Use By”, “Best Before” dates on the packaging.

DO	DON'T
Defrost food from the freezer thoroughly in a fridge or in a microwave oven following defrosting and cooking instructions.	Use pointed sharp edged objects such as knives, forks to remove the ice.
Defrost frozen meat completely before cooking.	Put hot food in the freezer. Let it cool down first.
Store commercially frozen food in accordance with the instructions given on the packets that you buy.	Put liquid-filled bottles or sealed cans containing carbonated liquids into the freezer as they may burst.
Check contents of the refrigerator at regular intervals.	Remove items from the freezer with wet hands.
Clean and defrost your refrigerator regularly.	Freeze fizzy drinks.
Prepare fresh food for freezing in small portions to ensure rapid freezing.	Consume ice-cream and water ices direct from freezer. It may cause “freezer burns” on lips.
Always choose high quality fresh food and be sure it is thoroughly clean before you freeze it.	Store poisonous or dangerous substances in the freezer.
Wrap all foods in aluminum foil or freezer quality plastic bags and make sure any air is excluded.	
Wrap frozen food when you buy it and put it into the freezer shortly.	
Keep food for as short a time as possible and adhere to “Best Before”, “Use By” dates.	

**For more about storing, download the App and visit “Tips & Hints”.**

- It’s suggested to set the temperature at 4°C in the fridge compartment, and, where possible, at -18°C in the freezer compartment.
- For most food categories, the longest storage time in the fridge compartment is achieved with colder temperatures. Since some particular products (as fresh fruits and vegetables)

may be damaged with colder temperatures, it is suggested to keep them in the crisper drawers, whenever present. If not present, maintain an average setting of the thermostat.

- For frozen food, refer to the storage time written on the food packaging. This storage time is achieved whenever the setting respects the reference temperatures of the compartment (one-star -6°C, two stars -12°C, three stars -18°C)

**Position different food in different compartments according to be below table**

Refrigerator compartment	Type of food
Door or balconies of fridge compartment	<ul style="list-style-type: none"> <li>• Foods with natural preservatives, such as jams, juices, drinks, condiments.</li> <li>• Do not store perishable foods</li> </ul>
Crisper drawers (salad drawer)	<ul style="list-style-type: none"> <li>• Fruits, herbs and vegetables should be placed separately in the crisper bin</li> <li>• Do not store bananas, onions, potatoes, garlic in the refrigerator</li> </ul>
Fridge shelf – middle	<ul style="list-style-type: none"> <li>• Dairy products, eggs</li> </ul>
Fridge shelf – top	<ul style="list-style-type: none"> <li>• Foods that do no need cooking, such as ready-to-eat foods, deli meats, leftovers.</li> </ul>
Freezer drawer(s)/tray	<ul style="list-style-type: none"> <li>• Foods for long-term storage</li> <li>• Bottom drawer for raw meet, poultry, fish</li> <li>• Middle drawer for frozen vegetables, chips.</li> <li>• Top tray for ice cream, frozen fruit, frozen baked goods.</li> </ul>

## ENERGY SAVING

For better energy saving we suggest:

- Installing the appliance away from heat sources and not exposed to direct sunlight and in a well-ventilated room.
- Avoid putting hot food into the refrigerator to avoid increasing the internal temperature and therefore causing continuous functionalizing of the compressor.
- Do not excessively stuff foods so as to ensure proper air circulation.
- Defrost the appliance in case there is ice to facilitate the transfer of cold.
- In case of absence of electrical energy, it is advisable to keep the refrigerator door closed.
- Open or keep the doors of the appliance open as little as possible.
- Avoid adjusting the setting to temperatures too cold.
- Remove dust present on the rear of the appliance.

## **TAKE CARE**

### **Defrosting**

This appliance has automatic defrosting system, no need to defrost by hand.

### **Cleaning and Care**

After defrosting you should clean the Fridge/Freezer internally with a weak solution of bicarbonate of soda. Then rinse with warm water using a damp sponge or cloth and wipe dry. Wash the baskets in warm soapy water and ensure they are completely dry before replacing in the Fridge/Freezer. Condensation will form on the back wall of the Fridge; however it will normally run down the back wall and into the drain hole behind the salad bin.

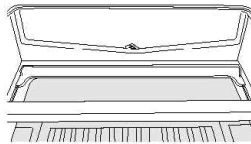

The drain hole will have a “cleaning spike” inserted into it. This ensures that small pieces of food can not enter the drain. After you have cleaned the inside of your Fridge and removed any food residues from around the whole, use the “cleaning spike” to make sure that there are no blockages. Use standard furniture polish to clean the Fridge/Freezer exterior. Make sure that the doors are closed to prevent polish getting on the magnetic door seal or inside. The grille of the condenser at the back of the Fridge/Freezer and the adjacent components can be vacuumed using a soft brush attachment. Do not use harsh cleaners, scouring pads or solvents to clean any part of the Fridge/Freezer.

## **CHANGING THE INTERNAL LIGHT**

1. Before carrying out the LED replacement always disconnect the mains supply.
2. Hold and lift up the LED light cover.
3. Remove the old LED by unscrewing it in an anti-clockwise direction.
4. Replace with a new LED light by screwing it in a clockwise direction making sure that it is secure in the light holder.
5. Refit the light cover and re-connect your Fridge to the mains supply and switch on.

## REVERSING THE DOOR SWING

### Dissemble the Refrigerator Door

1.
  - a. Use a tool to remove the screw off the hinge cover, and then remove the latter. Insert the communication line to the hole on the cabinet top.
  - b. Use a tool to remove the 4 screws off the upper hinge cover and then remove the latter.  
Pry up the door bush and small end cap cover on the door.

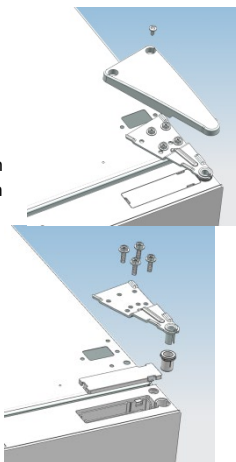
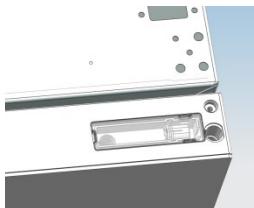

- c. Insert the door bush and door communication line into the hole on the door and then put on the small end cap cover.

- d. Use a tool to remove the 2 screws as shows in the below figure to remove the hole cover on the cabinet top and get the cabinet communication line out of the hole.  
Pry up the small end cap cover on the door and get out the door bush and door communication line.

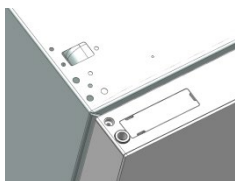
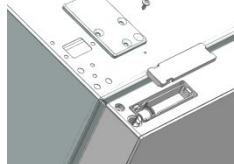

- e. Insert the door bush into the round hole on the door and then put on the small end cap cover.

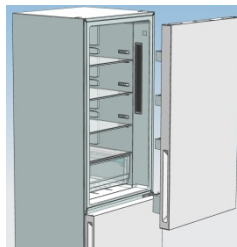

- f. Move the refrigerator door upward over 500mm to remove the door.



2.
  - a. Use a tool to remove the 3 screws off the middle hinge cover and then remove the middle hinge.
  - b. move the freezer door upward over 500mm to remove the door.

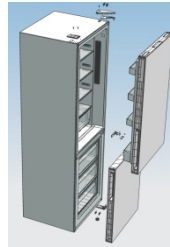
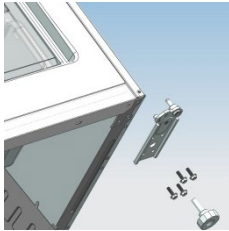
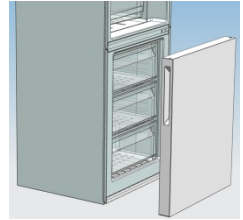
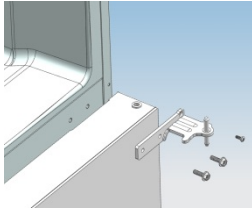

- c. Remove the adjustable front feet under the lower hinge; use a tool to remove the 4 screws from the lower hinge and then disassemble the lower hinge. Door disassembly is finished.

The pictures are for illustrative purposes only.

### Assemble door, lower hinge accessories to the corresponding positions

1.
  - a. Use a tool to get the door bush out as shown in the below figure and assemble it to the corresponding position of the other side.

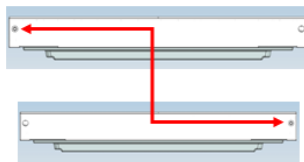

- b. Use a tool to remove the screws off the stopper ass as shown in the below figure and then assemble them to the other side of the door.



- c. Use a tool to remove the axle and two stoppers on the lower hinge and then assemble them to the position as shown in the below figure.

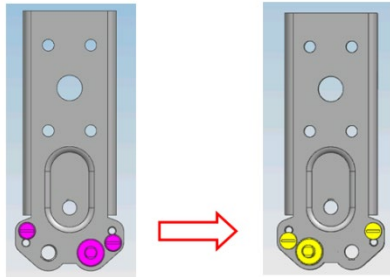

This situation apply to open door in right side This situation apply to left side  
The pictures are for illustrative purposes only.

### **Assemble the refrigerator door and freezer door to the opposite side**

1. a. Remove the adjustable front foot as shown below by hand and then assemble the lower hinge to the other side of the cabinet and fix the screws by using a tool.

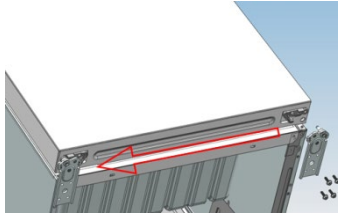

- b. Assemble the shorter adjustable front foot to the lower hinge side and adjust the height of the foot to make the refrigerator stay in level.

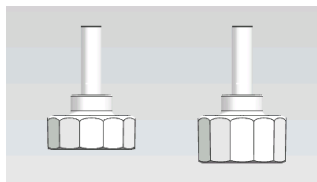

2. Put on the freezer door and turn the middle hinge by 180 °C and then assemble it to the other side of the cabinet; use a tool to screw up the 3 screws to fix the middle hinge.

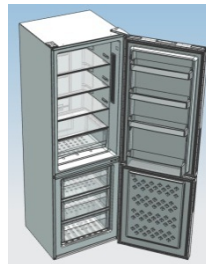
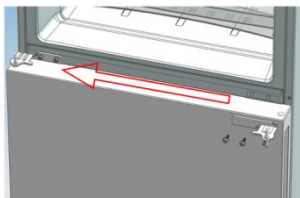

3. Put on the refrigerator door and assemble the upper hinge to the other side of the cabinet; use a tool to screw up the 4 screws to fix the upper hinge.  
After that, connect the door communication line and the cabinet communication line and then put on the upper hinge cover and fix it using a screw.
4. Assemble the hole cover to the other side of the cabinet and use a tool to screw up the hole cover.



Door disassembly is finished here.

figure of door opening from the right

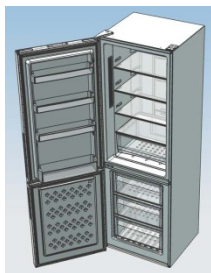

figure of door opening from the left



Double check that the door is aligned correctly and all the seals are closed on all sides. If necessary, re-adjust the levelling feet.

**NOTE:** If you want to have the door swing reversed, we recommend that you contact a qualified technician. You should only try to reverse the door yourself if you believe that you are qualified to do so. All parts removed must be saved to do the reinstallation of the door. You should rest the fridge freezer on something solid so that it will not slip during the door change process. Do not lay the fridge freezer flat as this may damage the coolant system. Ensure the fridge freezer is unplugged and empty. We recommend that 2 people handle the fridge freezer during assembly.

The pictures are for illustrative purposes only.

## TROUBLE SHOOTING

- If the appliance does not operate when switched on, check.
- Power cut: If the internal temperature of the Fridge/Freezer compartment is  $-18^{\circ}\text{C}$  or less when the power returns, your food is safe. The food in your Fridge/Freezer will remain frozen for approx 16 hours with the door closed. Do not open the Fridge/Freezer door more than necessary.
- The product is designed and built for domestic household use only.
- The plug is inserted properly in the socket and that the power supply is on. (To check the power supply to the socket, plug in another appliance).
- The fuse has blown/circuit breaker has tripped/main distribution switch has been turned off.
- The temperature control has been set correctly.
- If the refrigerator is exceptionally cold, you may have accidentally adjusted the thermostat control dial to a higher position.
- If the refrigerator is exceptionally warm, the compressor may not be working. Turn the thermostat control dial to the maximum setting and wait a few minutes. If there is no humming noise, it is not working. Contact the local store where your purchase was made.
- If condensation appears outside of the Refrigerator, this may be due to a change in the room temperature. Wipe off any residue of moisture. If the problem continues contact the local store where your purchase was made.
- If the provided plug has been replaced, make sure the new plug is properly connected. If the appliance is still not operating after the above checks, please contact Customer Service.
- To contact the technical assistance, visit our website: <https://corporate.haier-europe.com/en/> Under the section “website” , choose the brand of your product and your country. You will be redirected to the specific website where you can find the telephone number and form to contact the technical assistance

## Scrapping old appliances



This appliance is marked according to the European directive 2012/19/EU on Waste Electrical and Electronic Equipment (WEEE).

WEEE contains both polluting substances (which can cause negative consequences for the environment) and basic components (which can be re-used). It is important to have WEEE subjected to specific treatments, in order to remove and dispose properly all pollutants, and recover and recycle all materials.

Individuals can play an important role in ensuring that WEEE does not become an environmental issue; it is essential to follow some basic rules:

- WEEE should not be treated as household waste;
- WEEE should be handed over to the relevant collection points managed by the municipality or by registered companies. In many countries, for large WEEE, home collection could be present.

In many countries, when you buy a new appliance, the old one may be returned to the retailer who has to collect it free of charge on a one-to-one basis, as long as the equipment is of equivalent type and has the same functions as the supplied equipment.

## Conformity

By placing the **CE** mark on this product, we are confirming compliance to all relevant European safety, health and environmental requirements which are applicable in legislation for this product.

## Guarantee

Minimum guarantee is: 2 years for EU Countries, 3 years for Turkey, 1 year for UK, 1 year for Russia, 3 years for Sweden, 2 years for Serbia, 5 years for Norway, 1 year for Morocco, 6 months for Algeria, Tunisia no legal warranty required.

## Availability of spare parts

“Thermostats, temperature sensors, printed circuit boards and light sources are available for a minimum period of seven years after placing the last unit of the model on the market.

Door handles, door hinges, trays and baskets for a minimum period of seven years and door gaskets for a minimum period of 10 year, after placing the last unit of the model on the market” .

For further information about the product, please consult <https://eprel.ec.europa.eu/> or scan the QR on the energy label supplied with the appliance

**CANDY HOOVER GROUP S.R.L.**  
Via Privata Eden Fumagalli  
20861 Brugherio Milan Italy